



Bush & Co.

Gilbert House 6 Mill Park, - £2,000 PCM

A delightful two double bedroom ground floor apartment conveniently located just a few minutes from the mainline train station and within walking distance of the City Centre and many local shops and amenities. The apartment benefits from having a secure parking space, spacious balcony, communal gardens and bicycle store.

Communal Entrance

Secure communal entrance leading to ground floor apartment

Entrance Hall

Spacious entrance hallway with large cupboard housing the washing machine and additional storage cupboard

Kitchen/Living Room

22'10" x 11'1" (6.97 x 3.40)

Open plan kitchen/living room with wooden flooring, breakfast bar and sliding patio doors leading to large balcony

The kitchen is fitted with a fridge freezer and electric hob and oven with extractor hood

Bedroom 1

12'5" x 10'5" (3.81 x 3.18)

Master double bedroom with wooden flooring, a full length window adding lots of natural light and wardrobe

Bedroom 2

11'1" x 6'9" (3.40 x 2.08)

Second double bedroom with carpet

Bathroom

Large tiled bathroom with shower over bath, storage cabinet, WC, hand basin and large mirror

Parking

Secure underground parking space for one car

Key Information

EPC Rating – C

Council Tax Band – C (Cambridge City Council)

Rent – £2000 pcm (£461 pw)

Deposit – £2307

Available furnished or unfurnished 25th April 2026

Long term tenancy

- Two Bedroom Apartment
- Ground Floor
- Furnished/Unfurnished
- Secure Allocated Parking
- Bicycle Store
- Central Location
- 59.8 sqm / 644 sqft
- Pretty Communal Gardens
- Gas Central Heating
- Fully Double Glazed

IMPORTANT NOTICE

These particulars, whilst believed to be accurate are set out as a general outline only for guidance and do not constitute any part of an offer or contract. Intending tenants should not rely on them as statements of representation of fact, but must satisfy themselves by inspection or otherwise as to their accuracy. No person in this firm's employment has the authority to make or give any representation or warranty in respect of the property.

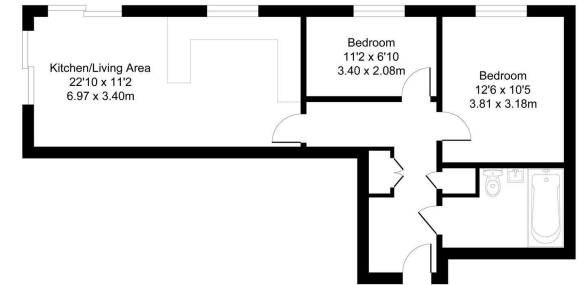

Total Area: 59.8 m² ... 644 ft²
All Measurements are approximate and for display purposes only

